

DA470
SHADOW STUDY -
WINTER SOLSTICE

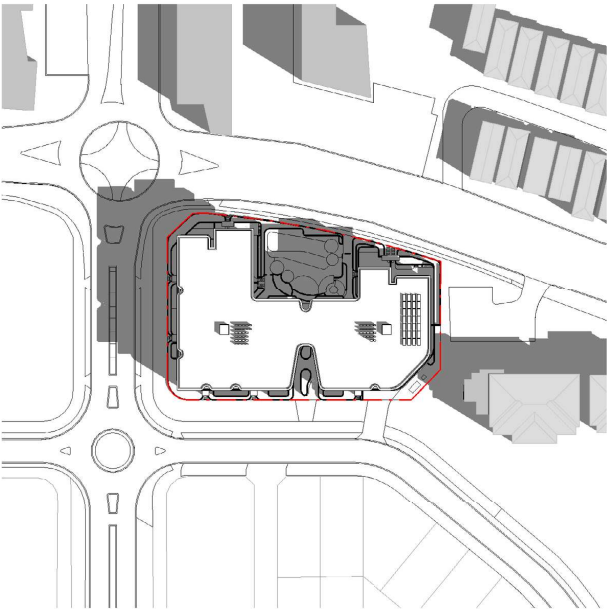

WINTER SOLSTICE | 9 AM
21 JUNE 2021

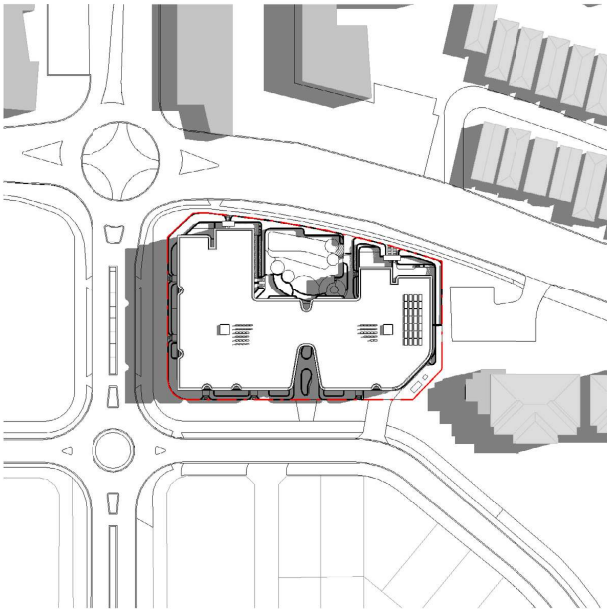

WINTER SOLSTICE | 12 PM
21 JUNE 2021

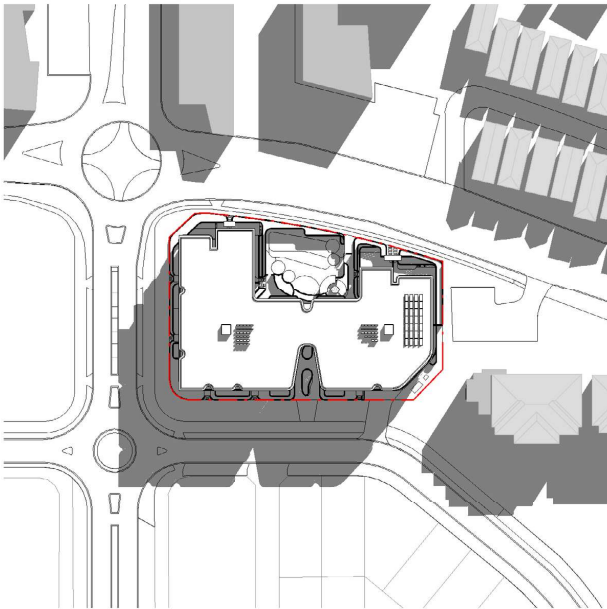

WINTER SOLSTICE | 3 PM
21 JUNE 2021

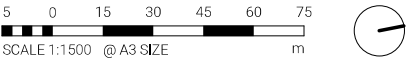

DA490
SHADOW STUDY -
SUMMER SOLSTICE

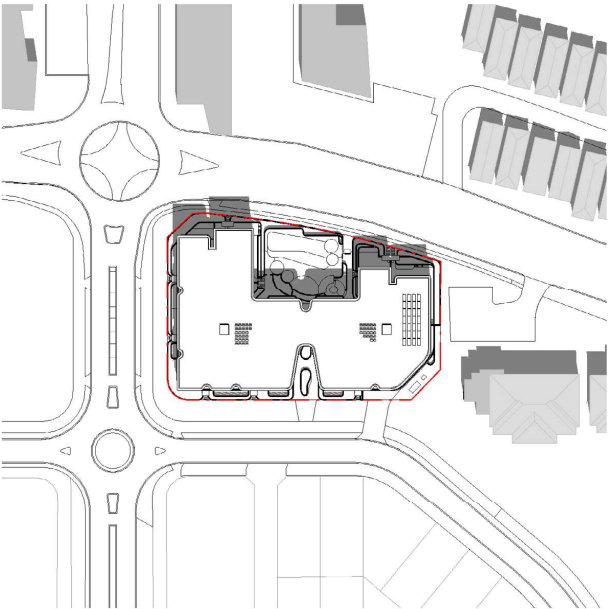

SUMMER SOLSTICE | 9 AM
22 DECEMBER 2021

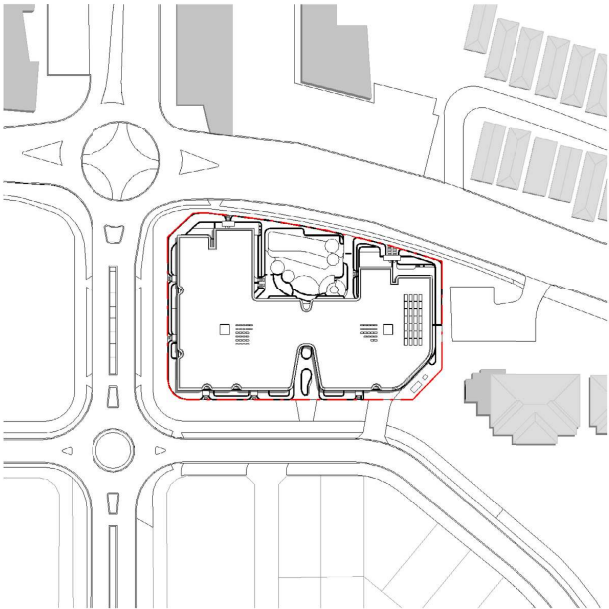

SUMMER SOLSTICE | 12 PM
22 DECEMBER 2021

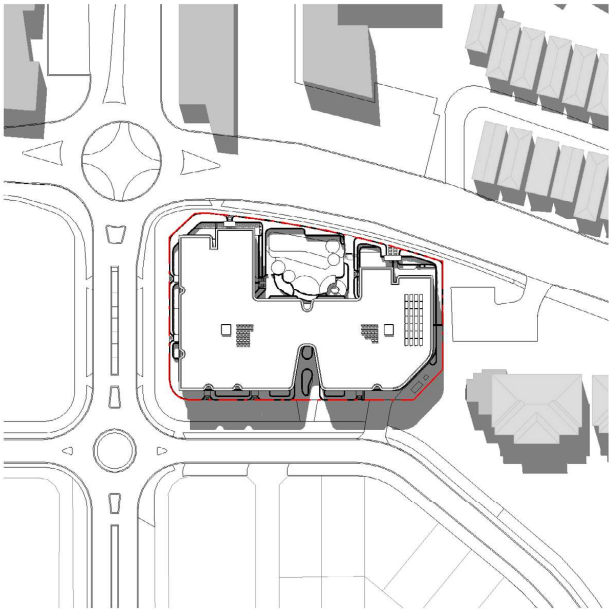

SUMMER SOLSTICE | 3 PM
22 DECEMBER 2021

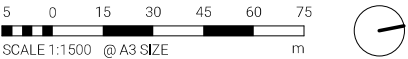

DA491
SHADOW STUDY - WESTERN FACADE EXPOSURE - WINTER SOLSTICE



FACADE - NORTH WEST - WINTER SOLSTICE 9 AM
21 JUNE 2021



FACADE - NORTH WEST - WINTER SOLSTICE 12 PM
21 JUNE 2021



FACADE - NORTH WEST - WINTER SOLSTICE 3 PM
21 JUNE 2021



FACADE - SOUTH EAST - WINTER SOLSTICE 9 AM
21 JUNE 2021



FACADE - SOUTH EAST - WINTER SOLSTICE 12 PM
21 JUNE 2021



FACADE - SOUTH EAST - WINTER SOLSTICE 3 PM
21 JUNE 2021



FACADE - SOUTH WEST - WINTER SOLSTICE 9 AM
21 JUNE 2021



FACADE - SOUTH WEST - WINTER SOLSTICE 12 PM
21 JUNE 2021



FACADE - SOUTH WEST - WINTER SOLSTICE 3 PM
21 JUNE 2021

NOMINATED ARCHITECT (NSW):
DANILO JURIC 10397

DA492
SHADOW STUDY - WESTERN FACADE LATE AFTERNOON EXPOSURE - SUMMER SOLSTICE

IN THE PEAK OF SUMMER BETWEEN NOON AND 3PM (HOTTEST TIME OF THE DAY) THE BALCONIES SHADE THE GLAZING AND PREVENT EXCESSIVE HEAT GAINS AS WELL AS GLARE TO WEST FACING APARTMENTS



FACADE - WEST - SUMMER SOLSTICE 3 PM
22 DECEMBER 2021

LATER IN THE AFTERNOON WHEN IT STARTS COOLING DOWN, THE WINDOWS WILL RECEIVE DIRECT SUNLIGHT. HOWEVER AS CAN BE SEEN BELOW THE BALUSTRADES AND BALCONIES STILL PROVIDE A DECENT AMOUNT OF PROTECTION. WE ARE CONCERNED THAT INTRODUCING MORE VERTICAL SUN SHADING TO THE WESTERN FACADE WOULD IMPACT VIEWS AND BUILDING AESTHETICS WITHOUT SIGNIFICANT CONTRIBUTIONS TO AMENITY



FACADE - WEST - SUMMER SOLSTICE 5 PM
22 DECEMBER 2021

APARTMENT TYPE 02 F (2 TOTAL) ARE MOST EFFECTED BY THE AFTERNOON SUN IN PEAK SUMMER. THE CORNER BALCONIES WILL PROVIDE MORE PROTECTION AGAINST EXCESSIVE HEAT GAINS AND GLARE AND A LARGER PORTION OF IMPACTED FACADE HAS BEEN DESIGNED AS SOLID. IT'S A CROSS VENTILATED CORNER UNIT WITH LARGE SLIDING DOORS. WE WOULD THEREFORE PREFER NOT TO ADD MORE VERTICAL SUNSHADING TO AVOID IMPACT ON VIEWS AND BUILDING AESTHETICS.



FACADE - WEST - SUMMERSOLSTICE 7 PM (SUNSET)
22 DECEMBER 2021